



**ENNOBLE IP**  
Sets Knowledge Through Action

# **DESIGN & PATENT ILLUSTRATION SERVICES**

# ABOUT US

Ennoble IP is a global professional services provider offering IP research, analytics, Legal and prosecution services. We are Market leaders in Research & Analytics, and Legal services including Patent, Design and Technical Intelligence. Being the market leader in the Research & IP industry, Ennoble IP team has experts such as patent analysts, innovation intelligence specialists, technical specialists, licensing analysts, patent agents, and IP docketing specialists who work diligently on intellectual property search, intelligence, prosecution solution. Our workforce possess an invaluable, cumulative experience of over 100+ years which helps us in guiding our clients on how to handle their intangible assets.



# ENTRACE

**EnTrace** the illustration/Designing vertical of Ennoble IP, dedicated for providing quality designs and illustration work for patent and design patent.

A patent application still needs high quality patent drawings to get it granted and Design Patent/Design registration requires the best quality 3D or 2D images.

Our team of handpicked qualified illustrators have backgrounds in engineering, design and arts. We thoughtfully consider each project and prepare drawings that have an aesthetic look and meet patent and Design office guidelines (IPO, USPTO, EPO, PCT and Other offices).





# SERVICES

We provide illustration services for following:

01 Patent Drawing  
(Specification)

02 Utility Patent  
Drawing

03 Design Patent  
Drawing

04 Technical  
Illustration

05 Product &  
Prototype  
Design



# WHY WE?

- Quality, Accuracy and timely delivery is our priority
- Trained and experience , well versed with CAD, AutoCAD, SolidWorks, and PTC software & product can be provided in any format viz. PDF, JPEG, GIF, TIFF, BMP, MSWORD,
- 3D and 2D designs experts
- We Have Expertise in Mechanical, Electrical, Electronics, Chemical & Biotech Drawings, Flow-charts And Graphical Interfaces



# SAMPLE DRAWINGS

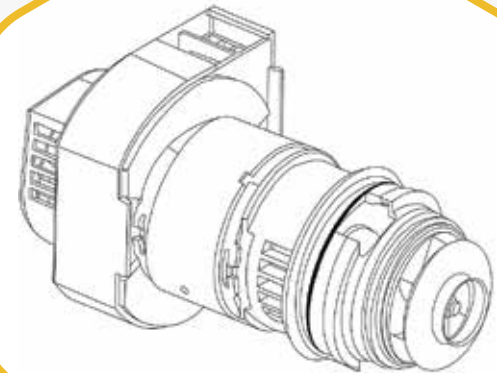
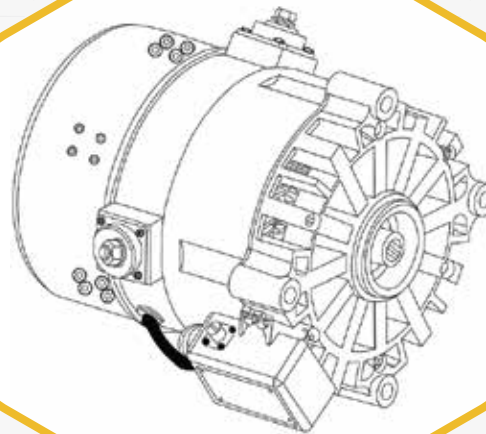
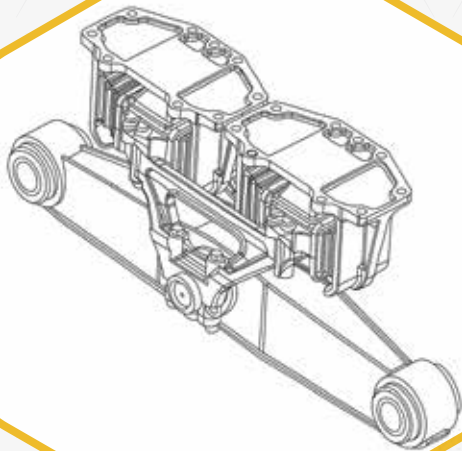
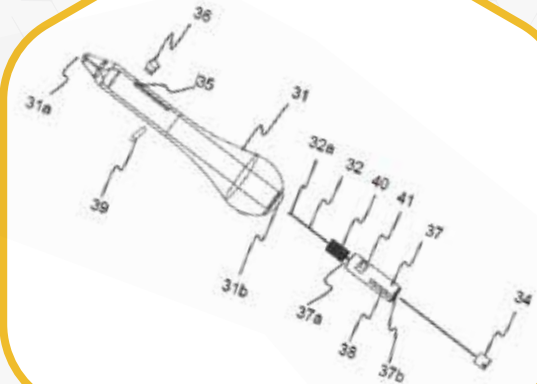
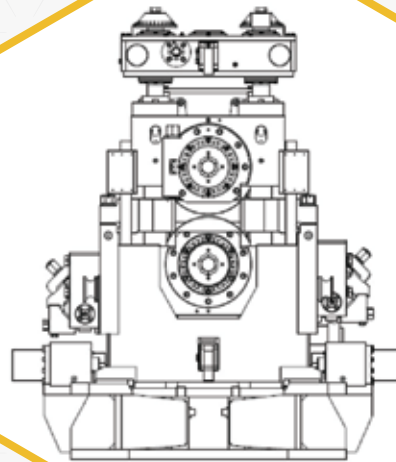

# SAMPLE DRAWINGS

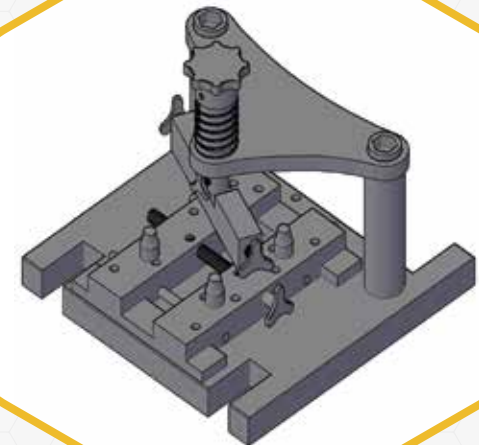
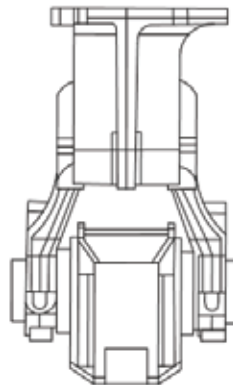
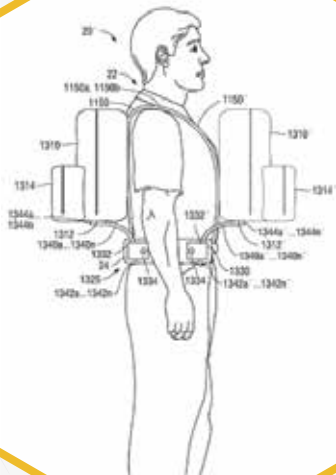
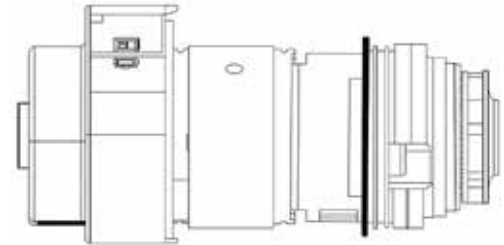
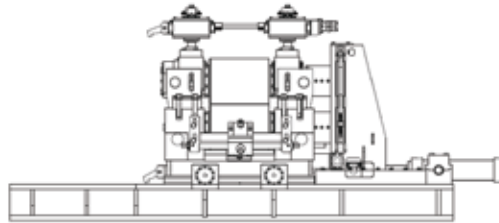
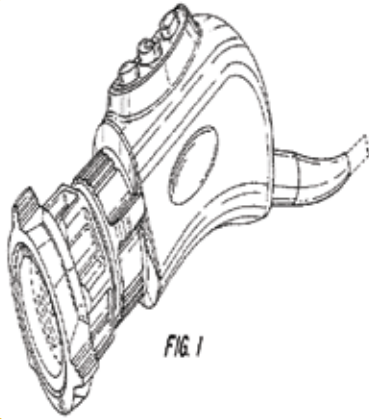



# CONTACT US

**Phone :** +91 99581 66931

**Gmail :** [contact@ennobleip.com](mailto:contact@ennobleip.com)

**Address :**

**India :** B-17, Sector 6, Noida, Uttar Pradesh  
(201301), India

**Dubai :** Office No- 1113, Concord Tower, Media  
City, Palm Jumeirah, Dubai

**Austrelia :** 25-31 mccubbin court, new beith, qld,  
4124 Australia



**ENNOBLE IP**  
Sets Knowledge Through Action

